

Steering: Specifications**Torque Specifications**

Description	Nm	lb-ft	lb-in
Steering column intermediate shaft pinch bolt	25	18	—
Steering gear-to-frame bolts	165	122	—
Sector shaft housing bolts	68	50	—
Meshload adjuster lock nut	31	23	—
Valve housing-to-steering gear bolts	58	43	—
Steering gear valve housing bolt	50	37	—

Torque Specifications (Part 1)**Torque Specifications (Continued)**

Description	Nm	lb-ft	lb-in
Steering gear race nut	99	73	—
Power steering pressure line fitting at the power steering pump	20	15	—
Sector shaft arm-to-sector shaft nut	270	199	—
Steering gear ball return guide clamp bolts	6	—	53
Steering gear allen head race lock nut set screw	2.3	—	20
Power steering pump bolts	26	19	—
Power steering fluid cooler bolts	11	8	—
Drag link nut	92	68	—
Power steering pressure line fitting at steering gear	20	15	—
Power steering return hose fitting at steering gear	20	15	—
Steering wheel rotating torque	1.5	—	13
Sector shaft rotating torque	2.0	—	18

Torque Specifications (Part 2)

Torque Specifications

Description	Nm	lb-ft
Tie-rod adjusting sleeve nuts	49	36
Inner tie-rod end-to-drag link nut	95	70
Outer tie-rod end-to-spindle nut	95	70

Torque Specifications (Part 1)**Torque Specifications (Continued)**

Description	Nm	lb-ft
Steering damper RH bracket nut	80	59
Steering damper LH bracket nut	80	59
Steering sector shaft arm nut	270	199

Torque Specifications (Part 2)**Steering Linkage - Exploded View**

Steering Linkage - Exploded View

NOTE: E-250-450 shown, E-150 similar.

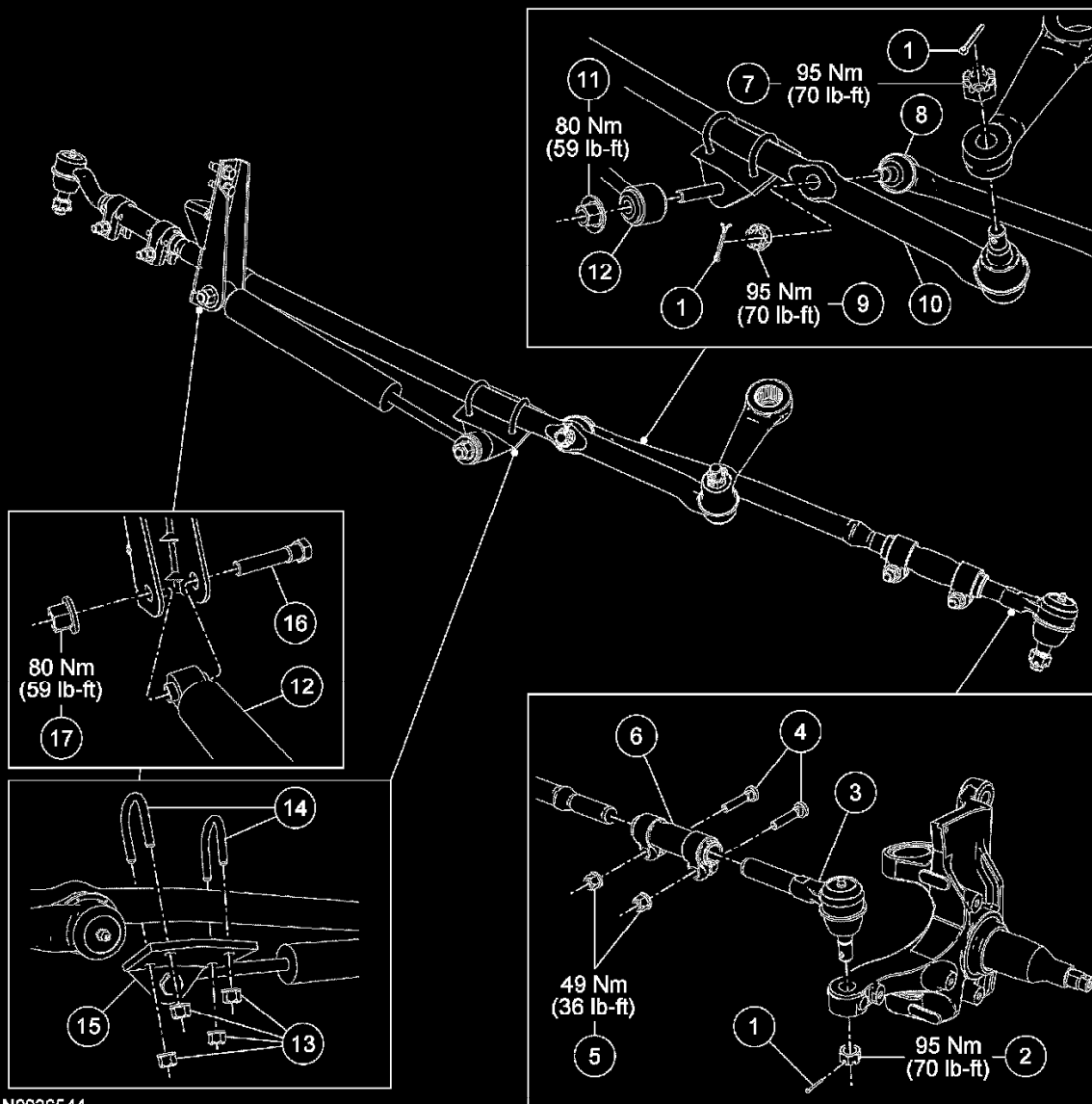

N0036544

Item	Description
1	Cotter pin (3 required)
2	Outer tie-rod end-to-wheel spindle nut (2 required)
3	Outer tie-rod end (2 required)
4	Adjusting sleeve bolt (2 required)

(Continued)

Item	Description
5	Adjusting sleeve nut (2 required)
6	Adjusting sleeve (2 required)
7	Drag link-to-sector shaft arm nut
8	Inner tie-rod end

(Continued)

NOTE: E-250-450 shown, E-150 similar. (Part 1)

Item	Description
9	Inner tie-rod end-to-drag link nut
10	Sector shaft arm drag link
11	Steering linkage damper-to-drag link bracket nut
12	Steering linkage damper
13	Steering linkage damper drag link bracket U-bolt nuts (4 required)
14	Steering linkage damper/drag link bracket U-bolts (2 required)

(Continued)

Item	Description
15	Steering linkage damper/drag link bracket
16	Steering linkage damper-to-frame bracket bolt
17	Steering linkage damper-to-frame bracket nut

NOTE: E-250-450 shown, E-150 similar. (Part 2)**General Specifications (Continued)**

Item	Specification
Minimum capacity	5.3 liters/minute (1.4 gpm) Fluid @ 74°-80°C (165°-176°F) Engine at idle Pressure at 5,171 kPa (750 psi)
Pressure	1,034 kPa (150 psi) Fluid @ 74°-80°C (165°-176°F) Engine at 1,500 rpm
Relief pressure (gas engines) 15,200 and 18,000 GVWR	9,000-9,900 kPa (1,300-1,430 psi)
Relief pressure (diesel engines)	9,652-10,550 kPa (1,400-1,530 psi)
Relief pressure 20,500	17,000 kPa (2,465 psi)

General Specifications**Torque Specifications**

Description	Nm	lb-ft
Meshload screw locknut	31	23
Drag link nut	90	66

Torque Specifications

General Specifications (Continued)

Item	Specification
Minimum capacity	5.3 liters/minute (1.4 gpm) Fluid @ 74°-80°C (165°-176°F) Engine at idle Pressure at 5,171 kPa (750 psi)
Pressure	1,034 kPa (150 psi) Fluid @ 74°-80°C (165°-176°F) Engine at 1,500 rpm
Relief pressure (gas engines) 15,200 and 18,000 GVWR	9,000-9,900 kPa (1,300-1,430 psi)
Relief pressure (diesel engines)	9,652-10,550 kPa (1,400-1,530 psi)
Relief pressure 20,500	17,000 kPa (2,465 psi)

General Specifications**General Specifications**

Item	Specification
Lubricants	
MERCON® Multi-Purpose ATF Transmission Fluid XT-2-QDX	MERCON®
Power Steering Gear	
Turning effort	31 Nm (23 lb-ft)
Turns lock-to-lock	4
Meshload	0.28-0.79 Nm (2.5-7 lb-in)
Steering gear preload	0.34-1.36 Nm (3-12 lb-in)
Meshload + preload (maximum)	2.15 Nm (19 lb-in)
Power Steering Purge Vacuum	68-85 kPa (20-25 in/hg)
Power Steering Pump	
Flow	10.6-12.0 liters/minute (2.8-3.2 gpm) Fluid @ 74°-80°C (165°-176°F) Engine at 1,500 rpm

General Specifications

General Specifications

Item	Specification
Lubricants	
Multi-Purpose Grease XG-4 and/or XL-5	ESB-M1C93-A
MERCON® Multi-Purpose ATF Transmission Fluid XT-2-QDX	MERCON®

General Specifications