

Evaporative Emission Control Canister: Service and Repair

EVAPORATIVE EMISSION CANISTER

Midship Fuel Tank Equipped Vehicles

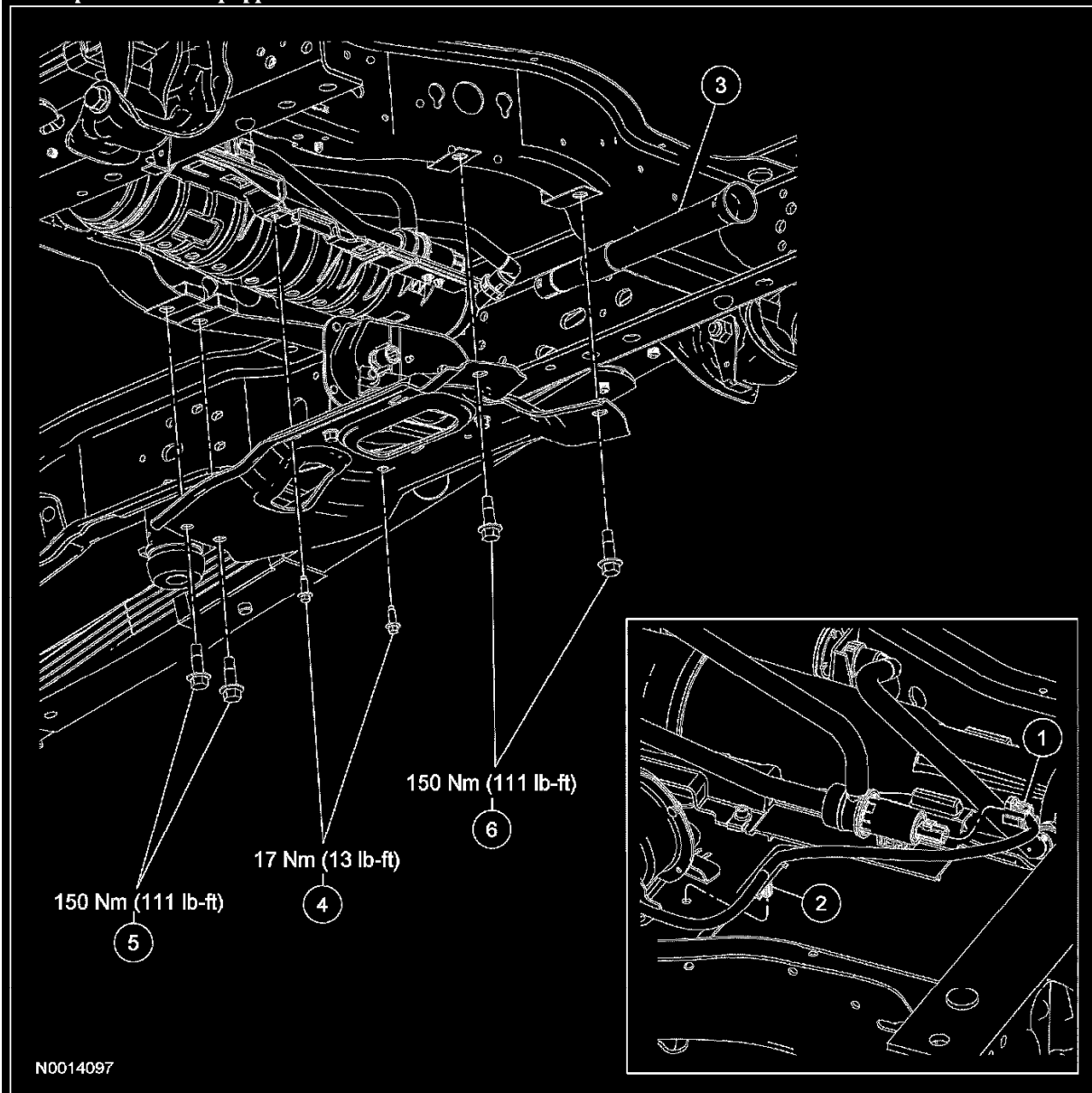

Item	Description
1	Evaporative emissions (EVAP) canister vent solenoid electrical connector
2	EVAP canister vent solenoid electrical harness retainer
3	Spare tire carrier extension tube

(Continued)

Item	Description
4	EVAP canister assembly bracket bolts (2 required)
5	Spare tire carrier assembly bracket bolts (2 required)
6	Spare tire carrier assembly bracket bolts (2 required)

Midship Fuel Tank Equipped Vehicles

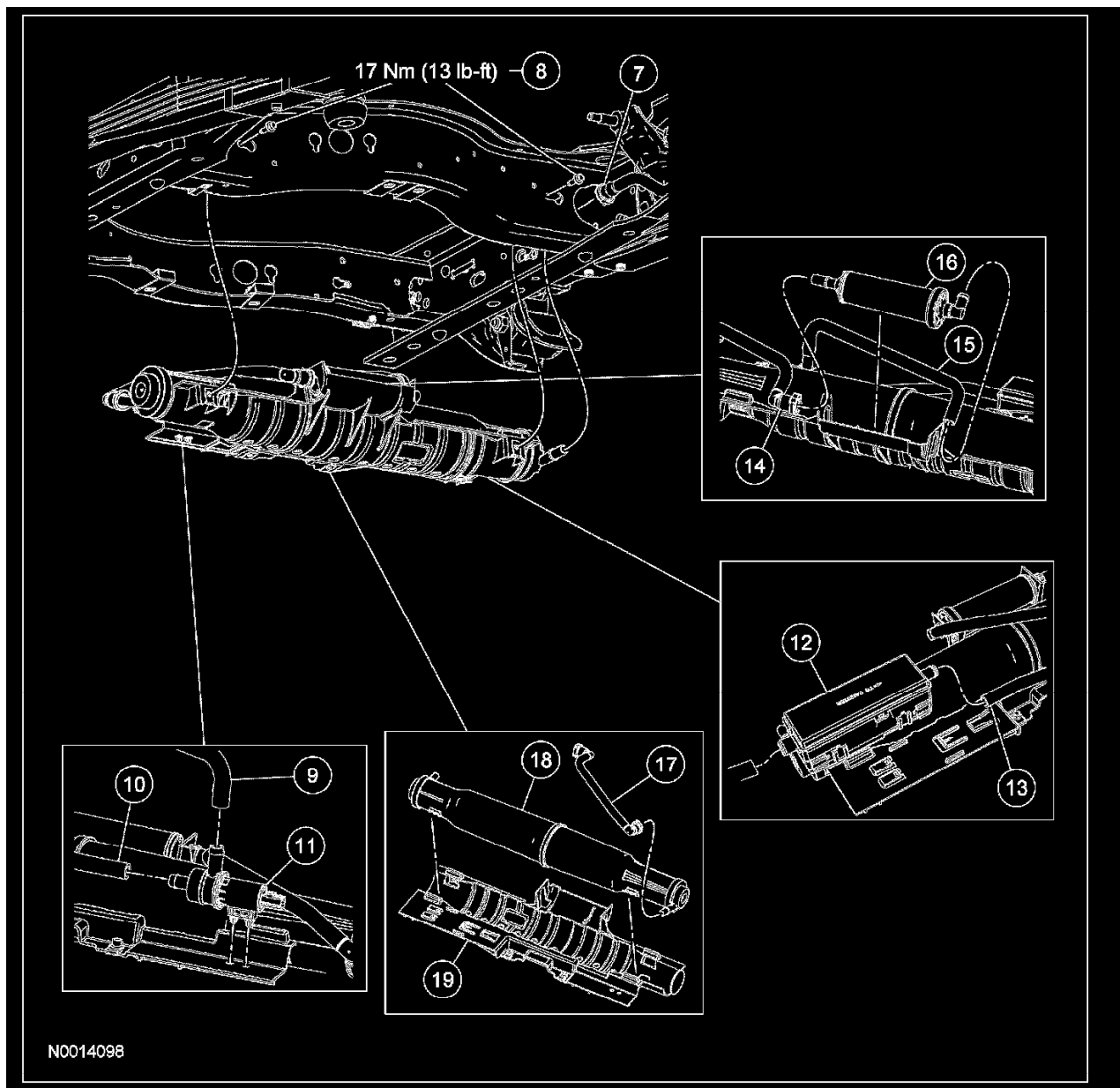

Part 1

Item	Description	Item	Description
7	Fuel vapor tube-to-evaporative emissions (EVAP) canister quick connect fitting	14	EVAP filter assembly-to-EVAP canister tube
8	EVAP canister assembly bracket bolts (2 required)	15	EVAP filter assembly-to-EVAP canister vent solenoid hose
9	EVAP filter assembly-to-EVAP canister vent solenoid hose	16	EVAP filter assembly
10	EVAP dust separator-to-EVAP canister vent solenoid hose	17	EVAP filter assembly-to-EVAP canister tube
11	EVAP canister vent solenoid	18	EVAP canister assembly (primary and bleed)
12	EVAP dust separator	19	EVAP canister assembly bracket
13	EVAP canister vent solenoid-to-EVAP dust separator hose		

(Continued)

Part 2

Aft Axle Fuel Tank Equipped Vehicles

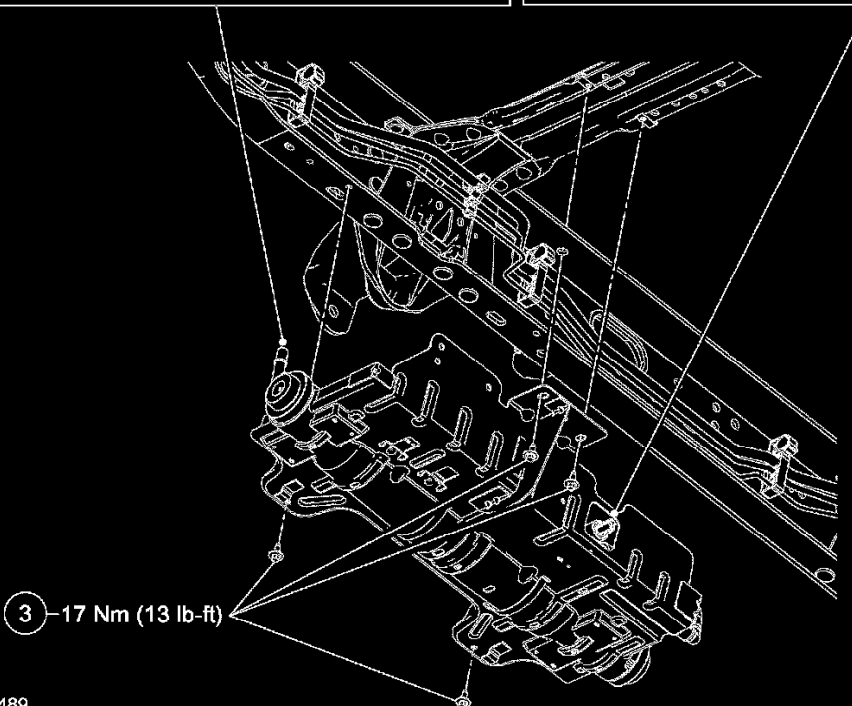
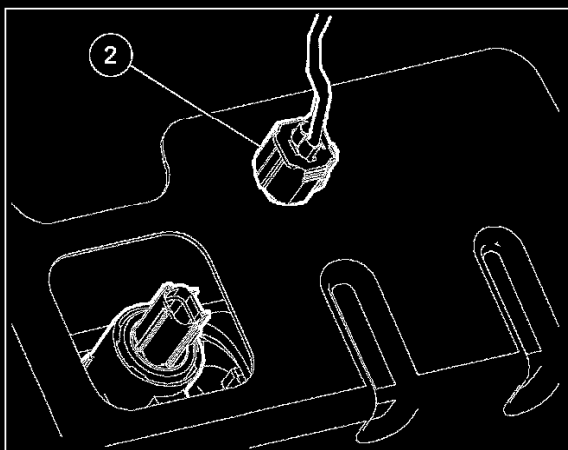
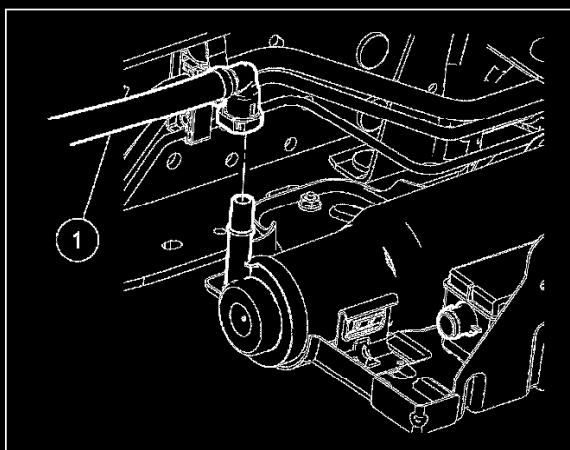

N0014489

Item	Description
1	Fuel vapor tube-to-evaporative emissions (EVAP) canister quick connect fitting
2	EVAP canister vent solenoid electrical connector

Item	Description
3	EVAP canister assembly bracket bolts (4 required)

(Continued)

Aft Axle Fuel Tank Equipped Vehicles (Part 1)

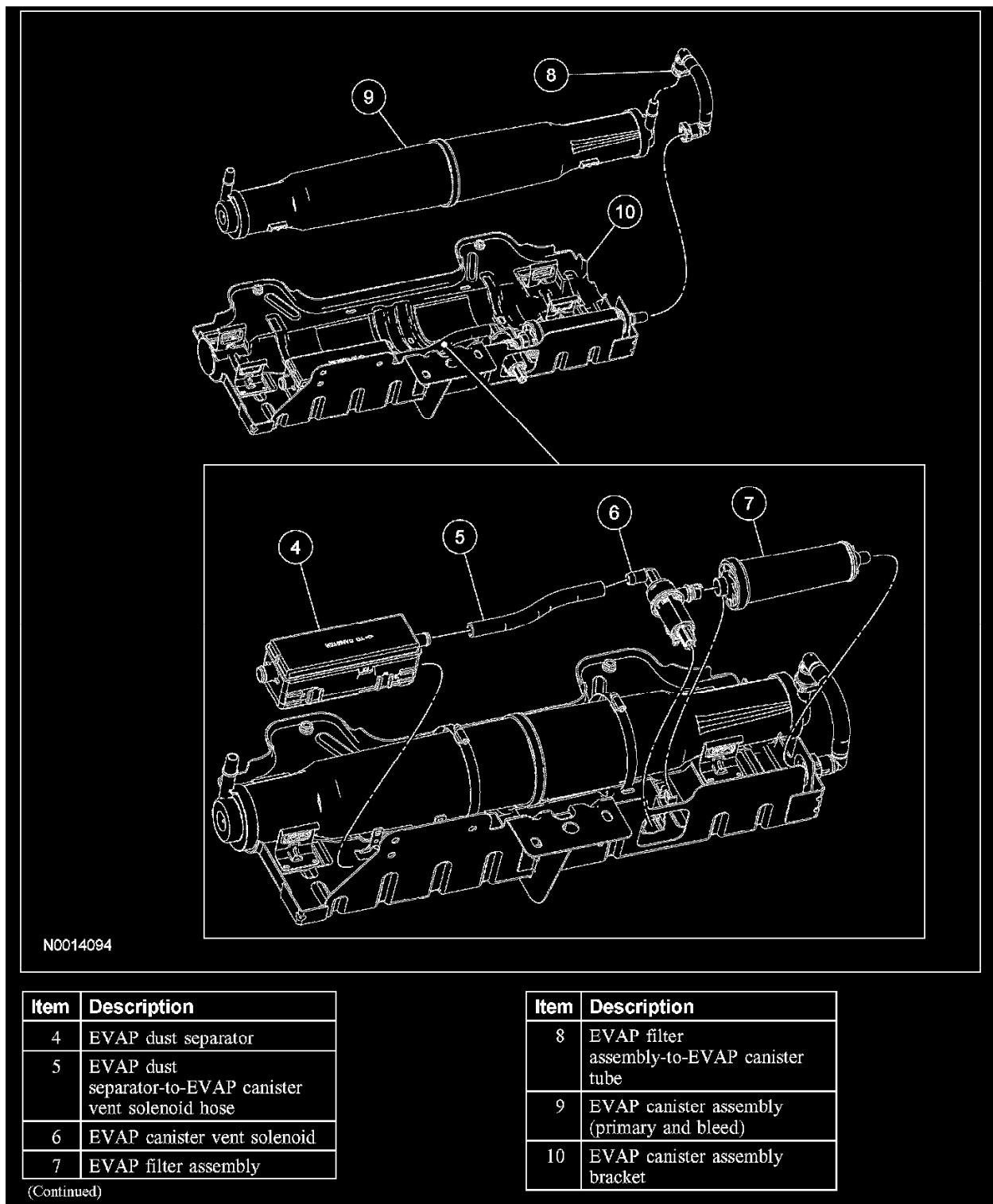

Aft Axle Fuel Tank Equipped Vehicles (Part 2)

Exploded View

Removal and Installation

WARNING:

- The evaporative emissions system contains fuel vapor and condensed fuel vapor. Although not present in large quantities, it still presents the danger of explosion or fire. Disconnect the battery ground cable from the battery to minimize the possibility of an electrical spark occurring, possibly causing a fire or explosion if fuel vapor or liquid fuel are present in the area. Failure to follow these instructions can result in personal injury.
- Do not smoke or carry lighted tobacco or open flame of any type when working on or near any fuel-related component. Highly flammable mixtures are always present and may be ignited. Failure to follow these instructions may result in personal injury.

All vehicles

1. With the vehicle in NEUTRAL, position it on a hoist.
2. Disconnect the battery ground cable.

Midship fuel tank equipped vehicles

3. Remove the spare tire.
4. Disconnect the spare tire carrier extension tube.
5. Disconnect the evaporative emissions (EVAP) canister vent solenoid electrical harness retainer from the spare tire carrier assembly.
6. Remove the 2 EVAP canister assembly bracket bolts.
 - To install, tighten to **17 Nm (13 lb-ft)**.
7. Remove the 4 spare tire carrier assembly bolts.
 - To install, tighten to **150 Nm (111 lb-ft)**.

All vehicles

8. Disconnect the EVAP canister vent solenoid electrical connector.
9. Disconnect the fuel vapor tube from the EVAP canister.
10. Disconnect the fuel vapor vent tube from the dust separator.

Midship fuel tank equipped vehicles

11. Remove the 2 bolts and the EVAP canister assembly.
 - To install, tighten to **17 Nm (13 lb-ft)**.

Aft axle fuel tank equipped vehicles

12. Remove the 4 bolts and the EVAP canister assembly.
 - To install, tighten to **17 Nm (13 lb-ft)**.

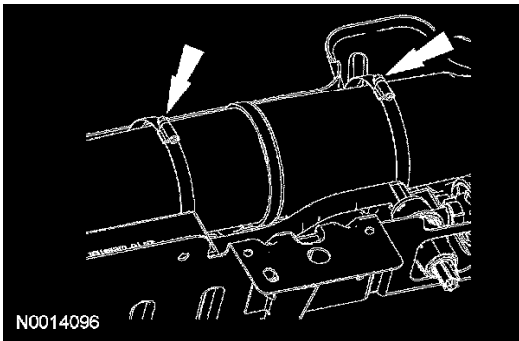

13. Remove the clamps from the EVAP canister assembly.

All vehicles

14. Place the EVAP canister bracket assembly on a clean work surface.
15. Disconnect the EVAP filter assembly-to-EVAP canister tube.
16. Remove the EVAP canister assembly from the EVAP canister bracket.
17. To install, reverse the removal procedure.
 - Carry out the evaporative emission system leak test. See: Testing and Inspection/Evaporative Emission System Leak Test
 - Carry out the evaporative emissions repair verification drive cycle. See: Testing and Inspection/Evaporative Emission Repair Verification Drive Cycle